



1900 Parrish Drive SE
Rome GA 30161

AFDHX60

DISC HARROW

MANUAL

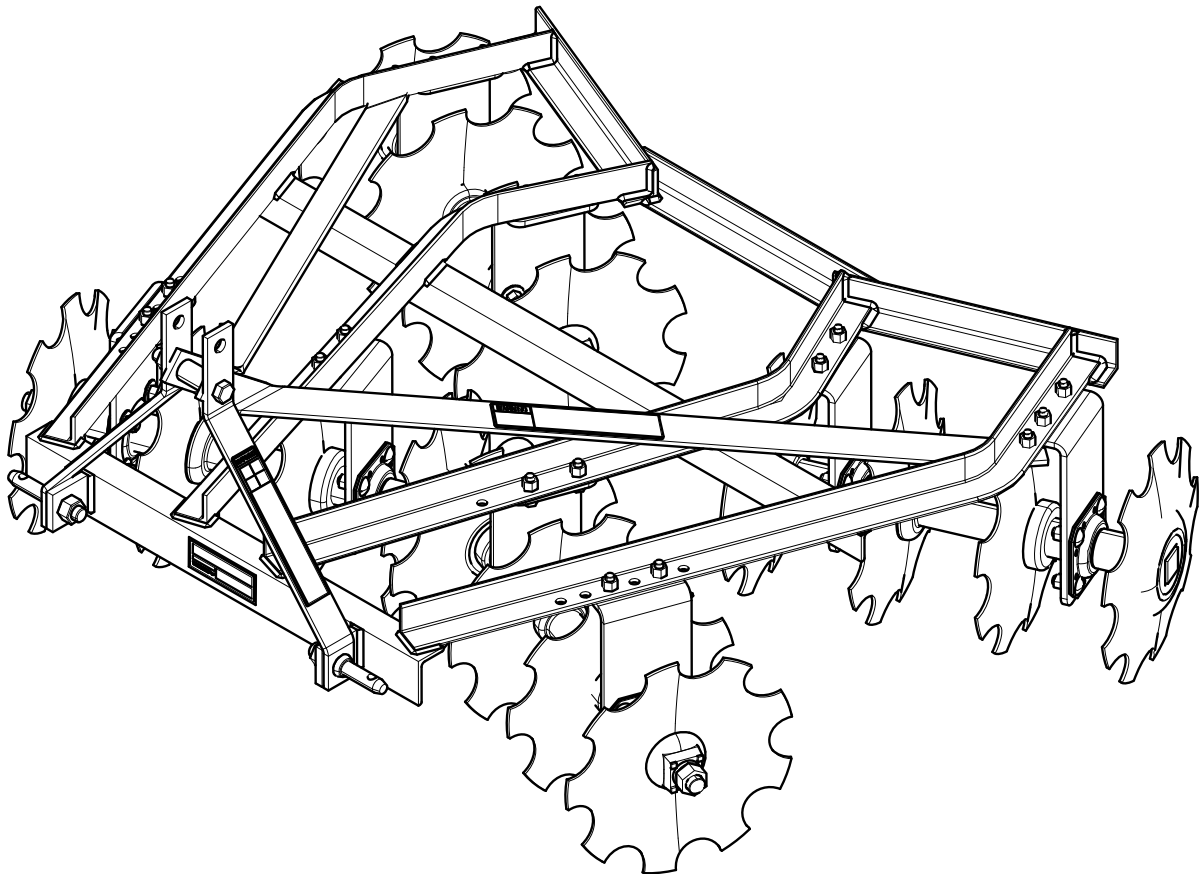

WELCOME TO THE WORLD OF SUMMIT TRACTORS

Thank you for purchasing your Summit Tractors attachment.

Read and become familiar with the operator's manual to learn how to operate and maintain your attachment safely. The operator's manual will help you avoid personal injury and other accidents during operation and servicing of the attachment.

By following the instructions contained in the manual, you will be able to operate the attachment so that it will provide long years of reliable service. Note that the images shown in this manual may differ from the actual attachment you have purchased.

The operator's manual is organized with sections arranged in a particular order so that the operator can better understand the safety messages and the controls on the attachment. The operator's manual also contains information about operation and service dates to support long years of reliability and use.

It is the customer's responsibility to ensure the implement is properly prepared and ready for use upon delivery. Before operating the implement, carefully inspect it to confirm all components are correctly installed and functioning as intended.

When using any attachment together with the tractor, carefully study the operator's manual of the tractor so that the attachment may be used safely and correctly.

All information, descriptions, specifications, drawings, illustrations, and pictures in this manual are based on the latest information available at the time this manual was published. Summit Tractors reserves the right to make changes at any time without prior notice.

TABLE OF CONTENTS

| | | | |
|------------------------------------|----|--|----|
| Introduction..... | i | Service..... | 13 |
| Safety..... | 1 | Tightening Disc Gangs..... | 13 |
| Description..... | 6 | Replacing Disc Blades/Bearing Hangers..... | 14 |
| Safety and Instruction Decals..... | 7 | Cleaning..... | 16 |
| Attaching..... | 9 | Storage..... | 16 |
| Leveling..... | 10 | Specifications..... | 17 |
| Detaching..... | 10 | Parts..... | 18 |
| Operation..... | 11 | Troubleshooting..... | 19 |
| Adjusting Gang Angles..... | 12 | Torque Specifications..... | 20 |
| | | Warranty..... | 21 |

CUSTOMER INFORMATION

Name _____

Purchased From _____

Date Purchased _____

Model _____



Serial # _____

PREPARATION CHECKLIST

Verify the following before operating your Disc Harrow

- | | |
|---|---|
| <input type="checkbox"/> 1. Disc Harrow is completely assembled. | <input type="checkbox"/> 4. All decals in place and readable (See Safety & Instruction Decals, page 7-8). |
| <input type="checkbox"/> 2. Overall condition good (i.e. paint, welds). | <input type="checkbox"/> 5. Check all bolts to be sure they are tight (See Torque Specifications Chart, page 20). |
| <input type="checkbox"/> 3. All cotter pins and safety pins are properly installed. | |

SAFETY GUIDELINES

 **ATTENTION! BECOME ALERT! YOUR SAFETY IS INVOLVED!** 

Safety is a primary concern in the design and manufacture of our products. Unfortunately, our efforts to provide safe equipment can be wiped out by an operator's single careless act.

In addition to the design and configuration of equipment, hazard control and accident prevention are dependent upon the awareness, concern, judgment, and proper training of personnel involved in the operation, transport, maintenance and storage of equipment.

It has been said: "The best safety device is an informed, careful operator." We ask you to be that kind of operator.

Throughout this manual, the term **IMPORTANT** is used to indicate that failure to observe procedures can cause damage to equipment. The terms **DANGER**, **WARNING** and **CAUTION** are used in conjunction with the Safety-Alert Symbol, (a triangle with an exclamation mark), to indicate the degree of hazard for items of personal safety.



This is the safety alert symbol. It is used to alert you to potential personal injury hazards. Obey all safety messages that follow this symbol to avoid possible injury or death.

 **DANGER**

Indicates an imminently hazardous situation that, if not avoided, will result in death or serious injury.

 **WARNING**

Indicates a hazardous situation which, if not avoided, could result in death or serious injury, and includes hazards that are exposed when guards are removed.

 **CAUTION**

Indicates a potentially hazardous situation that, if not avoided, may result in minor or moderate injury.

IMPORTANT

Indicates that failure to observe can cause damage to equipment.

NOTE

Indicates helpful information.

CALIFORNIA PROPOSITION 65

WARNING: Cancer and reproductive harm - www.p65warnings.ca.gov

At Summit Tractors, we care about your safety. Most accidents can be avoided by a few seconds of thought and a careful approach to handling equipment. You, the operator, can avoid many accidents by observing the following precautions and insist those working with you follow them too.

If you need assistance or a replacement manual and safety decals, go to summittractors.com or call an authorized Summit Tractors dealer.

PLEASE READ YOUR TRACTOR/AUV/UTV (POWER UNIT) MANUAL BEFORE ASSEMBLING OR OPERATING YOUR SUMMIT TRACTORS IMPLEMENT.

In order to provide a better view, certain photographs or illustrations in this manual may show an assembly with a safety shield removed. However, an implement should never be operated in this condition. Keep all shields in place. If shield removal becomes necessary for repairs, replace the shield prior to use.

Replace any safety decal that is illegible or missing. Location of such safety decals are indicated in this manual.

Never use alcoholic beverages or drugs that can hinder alertness or coordination while operating the power unit or the implement. Consult your doctor about operating this machine while taking prescription medications.

Under no circumstances should children under the age of 18 be allowed to operate the power unit or the implement. Do not allow persons to operate or assemble the implement until they have read this manual and have developed a thorough understanding of the safety precautions and how it works. Review the safety instructions with all users annually.

This implement can be dangerous to children and persons unfamiliar with its operation. The operator should be a responsible, properly trained and physically able person familiar with farm machinery and trained in this implement's operations.

Always use a power unit equipped with a Roll Over Protective System and seat belt (ROPS). Keep your seat belt securely fastened. Falling off the power unit can result in death from being run over or crushed.

Always keep a foldable ROPS system in the "locked up" position at all times.

Never exceed the limits of any piece of machinery, whether the power unit or the Summit Tractors implement. If its ability to perform a job safely is in question **DO NOT TRY IT.**

Do not modify the Summit Tractors implement in any way. Unauthorized modification could result in serious injury or death and may impair the function and life of the implement.

In addition to the design of this implement, including safety signs and safety equipment, hazard control and accident prevention are dependent upon the awareness, concern, prudence, and proper training of personnel involved in the operation, transport, maintenance and storage of the Summit Tractors implement. Refer also to safety messages and operation instruction in each of the appropriate sections of the power unit and Summit Tractors implement manuals. Heed the safety signs affixed to both the power unit and Summit Tractors implement.



Follow all safety rules and safety decal information.

Your Summit Tractors implement is attached to a power unit. You must know the controls of your power unit and how to stop the engine and implement quickly in an emergency. All operators must be capable to safely operate the power unit, its attachments, and all controls.

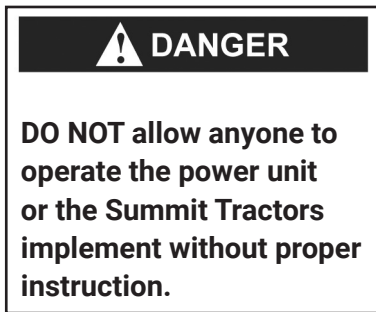

PREPARATION

Always wear relatively tight and belted clothing to avoid getting caught in any moving part. Wear sturdy, rough-soled work shoes and protective equipment for eyes, hair, hands, ears, and head. Wear respirator or filter mask when appropriate.

Check that all hardware is properly installed.

Always tighten to torque chart specifications unless instructed otherwise in this manual.

Make sure the Summit Tractors implement is properly secured, adjusted and in good operating condition.

A minimum of 20% of tractor weight must be on the tractor's front wheels when Summit Tractors implements are in use. Without this weight, the tractor could tip over, causing personal injury or death. The weight may be attained with a loader, front wheel weights, ballast in tires or front tractor weights. Weigh the tractor and Summit Tractors implement. **DO NOT ESTIMATE.**

Always use a power unit equipped with a Roll Over Protective System and seat belts (ROPS). Keep your seat belt securely fastened because falling off can result in your death from being run over or crushed.

Always keep a foldable ROPS system in the "locked up" position at all times.

TRANSPORTATION

Never transport the power unit or the implement while under the influence of alcohol or drugs.

Always comply with all federal, state and local laws regarding lighting, marking requirements and transportation of farm equipment on a public roadway.

Transport only in daylight or satisfactory artificial light.

Be aware of overhead utility lines.

Never allow riders on the power unit or Summit Tractors implement.

Watch for hidden hazards on the terrain during transport.

Do not operate or transport on steep slopes. Do not stop, start or change directions suddenly on slopes.

Use extreme care and reduce ground speed on slopes and rough terrain. When encountering rough terrain during transport, reduce the power unit speed to minimize the horizontal movement of the Summit Tractors implement.

Stabilizer bars should be used during transport to reduce lateral movement of the Summit Tractors implement.

Always use a power unit equipped with a Roll Over Protective System and seat belts (ROPS). Keep your seat belt securely fastened because falling off can result in your death from being run over or crushed.

Always keep a foldable ROPS system in the "locked up" position at all times.

Always sit in power seat when operating controls or starting engine. Securely fasten seat belt, place transmission in neutral, engage brake, and ensure all other controls are disengaged before starting power unit engine.

Ensure the towing vehicle and trailer are safely capable of transporting the Summit Tractors implement and that everything is properly secured.

OPERATION

Never operate the power unit or the Summit Tractors implement while under the influence of alcohol or drugs.

Operate only in daylight or satisfactory artificial light.

Always comply with all state and local lighting and marking requirements.

Do not allow bystanders in the area when operating, attaching, removing, assembling or servicing the power unit or Summit Tractors implement.

Never allow riders on the power unit or attachment.

Never discharge directly toward people, animals or property.

This Summit Tractors implement is intended for agricultural applications only. Do not operate within 300 feet of bystanders or public roads or highways.

Use extreme care when working close to fences, ditches, other obstructions, or on hillsides.

Keep hands, feet, hair and clothing away from the power unit and Summit Tractors implement while the power unit engine is running. Stay clear of all moving parts.

Always sit in the power unit seat when operating controls or starting engine. Securely fasten seat belt, place transmission in neutral, engage brake and ensure all other controls are disengaged before starting the power unit engine.

Look down and to the rear and make sure area is clear before operating in reverse. **REVERSE OPERATION IS NOT RECOMMENDED.**

Be aware that turning the power unit tightly may cause the Summit Tractors implement to come in contact with the rear wheels of the power unit and cause damage or injury.

Watch for hidden hazards on the terrain during operation.

Do not operate on steep slopes. Do not stop, start, or change directions suddenly on slopes.

Use extreme care and reduce ground speed on slopes and rough terrain. When encountering rough terrain, reduce the power unit speed to minimize the horizontal movement of the Summit Tractors implement.

Stop the power unit and equipment immediately upon striking an obstruction. Turn off engine, remove key, inspect, and repair any damage before resuming operation.

Before leaving operator's seat, lower lift arms and put attachment on the ground. Engage brake, stop engine, remove key, and remove seat belt.

Always use a power unit equipped with a Roll Over Protective System and seat belts (ROPS). Keep your seat belt securely fastened because falling off can result in your death from being run over or crushed.

Always keep a foldable ROPS system in the "locked up" position at all times.

MAINTENANCE

Make certain all movement of the power unit and Summit Tractors implement components has stopped before approaching for service.

Before detaching the power unit from the Summit Tractors implement or performing any service or maintenance, follow these steps: disengage power to the power unit, lower the 3-point hitch and all raised components to the ground, set parking brake, stop engine, remove key and unfasten seat belt.

Before working underneath the power unit or a Summit Tractors implement, carefully read this manual's instructions, raise implement, securely block up all corners with jack stands, and check stability. Secure blocking prevents a Summit Tractors implement from dropping due to hydraulic leak down, hydraulic system failures or mechanical component failures.

Never go underneath a Summit Tractors implement (lowered to the ground or raised) unless it is properly blocked and secured. Never place any part of the body underneath the power unit or a Summit Tractors implement or between movable parts even when the engine has been turned off. Hydraulic system leak down, hydraulic system failures, mechanical failures, or movement of control levers can cause a Summit Tractors implement to drop or rotate unexpectedly and cause severe injury or death. Follow the power unit and Summit Tractors implement manual for working underneath and blocking procedures.

Always wear relatively tight and belted clothing to avoid getting caught in any moving part. Wear sturdy, rough-soled work shoes and protective equipment for eyes, hair, hands, ears, and head. Wear respirator or filter mask when appropriate.

Keep all persons away from you while performing adjustments, service, or maintenance.

Frequently check blades/tines/shanks. They should be sharp, free of nicks and cracks and securely fastened. Do not handle blades/tines/shanks with bare hands. Careless or improper handling may result in serious injury.

Do not modify, alter, or permit anyone else to modify or alter the power unit, the Summit Tractors implement, or any of their components in any way, except as outlined in this manual.

Tighten all bolts, nuts, and screws to torque chart specifications unless otherwise indicated. Check that all cotter pins are installed securely to ensure equipment is in a safe condition before putting it into service.

STORAGE



Always use a power unit to position a Summit Tractors implement for storage.

Block the Summit Tractors implement securely for storage.

Keep children and bystanders away from storage area.

Your Disc Harrow has been carefully designed for cutting sod, breaking clumps, and leveling soil for seedbed preparation. This manual is provided to give you the necessary operation and maintenance instructions for keeping your Disc Harrow in excellent operating condition. Please read this manual thoroughly. Understand the purpose of the implement and how to use it. Observe all safety precautions on the machine and as noted throughout this manual. If any assistance or additional information is needed, contact your Summit Tractors dealer.

AFDHX60 Major Components

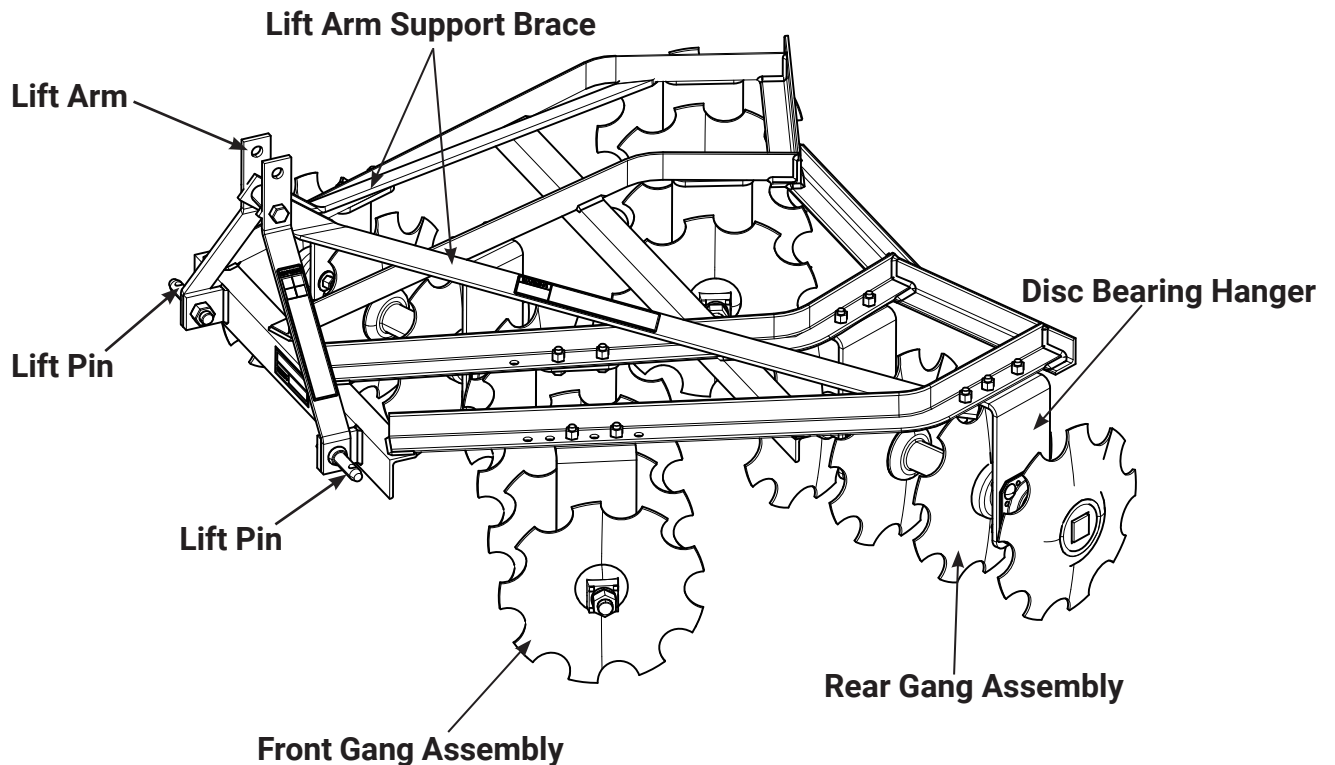

SAFETY & INSTRUCTION DECALS

⚠ ATTENTION! BECOME ALERT! YOUR SAFETY IS INVOLVED! ⚠
Replace Immediately if Damaged!

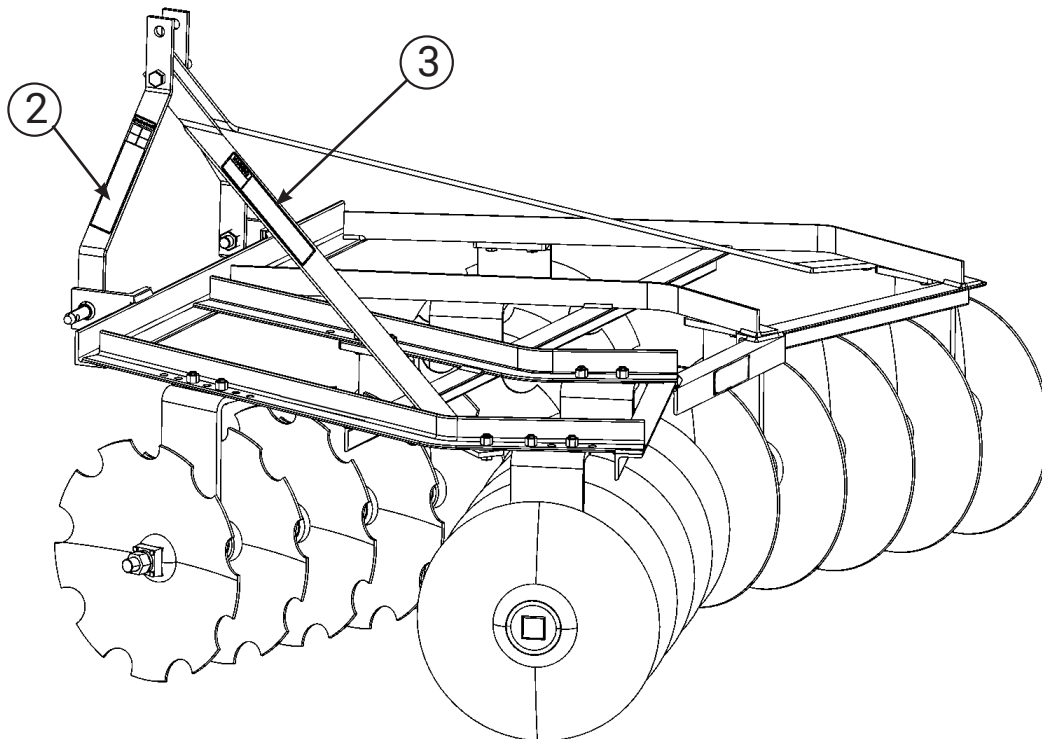
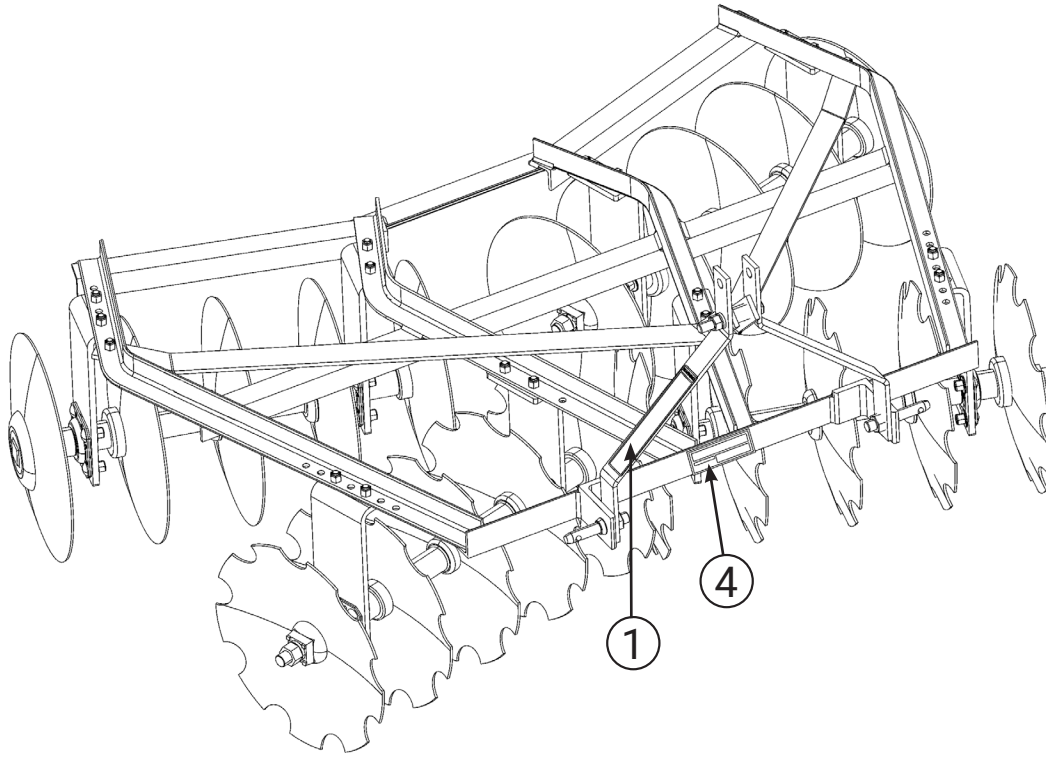

▲WARNING

TO AVOID SERIOUS INJURY OR DEATH:

- Read Operator's Manual before operating, servicing or repairing equipment. Follow all safety rules and instructions. (Manuals are available from your selling dealer.)
- Never allow riders.
- Keep bystanders away from equipment during operation.
- Operate from tractor seat only.
- Keep all shields in place and in good condition.
- Lower equipment to ground, stop engine, remove key and set brake before dismounting tractor.
- Never allow children or untrained persons to operate equipment.
- If equipped with a park stand, park stands must be functional, kept in good repair, and stored in unit. Park and store on hard level ground away from people and children.

FAILURE TO FOLLOW THESE INSTRUCTIONS CAN RESULT IN INJURY OR DEATH.

1 AVOID INJURY

▲WARNING



CRUSHING AND PINCHING HAZARD

- Be extremely careful handling various parts of the machine. They are heavy and hands, fingers feet, and other body parts could be crushed or pinched between tractor and implement.
- Operate tractor controls from tractor seat only.
- Do not stand between tractor and implement when tractor is in gear.
- Make sure parking brake is engaged before going between tractor and implement.
- Stand clear of machine while in operation or when it is being raised or lowered.

FAILURE TO FOLLOW THESE INSTRUCTIONS COULD RESULT IN SERIOUS INJURY OR DEATH.

2 CRUSHING & PINCHING

SUMMIT
TRACTORS

Serial Number
1XITLPTXKxxxxxxx



3-POINT IMPLEMENT

Assembled in USA
IT USA, 1900 Parrish Drive SE, Rome GA 30161

4 SERIAL NUMBER

▲WARNING

FALLING OFF CAN RESULT IN BEING RUN OVER.



FALLING OFF OR GOING UNDERNEATH IMPLEMENT CAN RESULT IN SERIOUS INJURY OR DEATH.

- Tractor must be equipped with ROPS (or ROPS CAB) and seat belt. Keep foldable ROPS systems in "locked up" position at all times.
- Buckle Up! Keep seat belt securely fastened.
- Allow no riders.

RAISED IMPLEMENT CAN DROP AND CRUSH.

- Never go underneath raised implement which can drop from equipment or tractor 3-point hitch hydraulic leak down, hydraulic system failures, movement of control levers, or mechanical linkage failures.
- Service work does not require going underneath implement. Read manual instructions.

3 FALLING OFF

ATTACHING

ATTACHING DISC HARROW TO TRACTOR WITH THREE POINT HITCH

The Disc Harrow is designed to be mounted on a 3-point tractor hitch. Model AFDHX60 has Category 0 spacing with Category 1 lift pins installed. **NOTE:** Refer to Specifications Chart on page 17 to ensure your implement is compatible with your tractor's horsepower rating.



WARNING

- To avoid bodily injury or machine damage whenever an implement is attached, put transmission in **PARK** position and/or engage the parking brake as applicable.
- Check full range of hitch for interference or binding.
- Do not stand between tractor and implement.
- Keep bystanders away from equipment.

1. Back up tractor to disc harrow with hitch points approximately in alignment.
2. Engage tractor parking brake and/or place transmission in "PARK". Shut off tractor engine and remove key.
3. Install tractor 3-point lower lift arms over lift pins and secure with quick lock pins (not included).

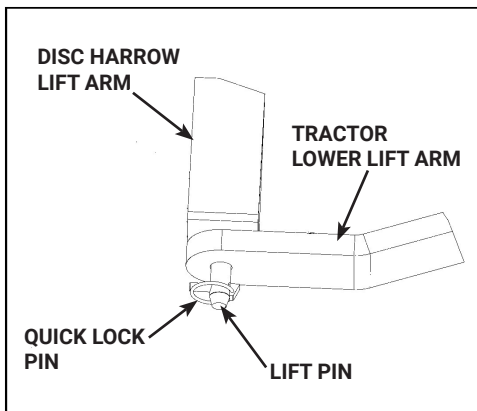

Figure 1 - Lower Lift Arm Attachment

4. Align tractor top link with upper hole in disc harrow lift arms.
5. Insert top link pin (not included) through upper hole and through tractor top link. Secure with quick lock pin.



Figure 2 - Top Link Attachment

6. Start tractor engine and slowly pull hitch control lever to raise disc harrow. Check for interference.
7. Lower disc harrow to the ground and adjust tractor top link until disc harrow is level with the ground when in the down position.



WARNING

- Hydraulic system leak down, hydraulic system failures, or movement of control levers can cause implement to drop or move unexpectedly and can cause serious injury or death.

LEVELING DISC HARROW

Level the disc harrow by adjusting the length of the tractor's top link.

Lengthening the top link will lower the rear of the disc harrow. Shortening the top link will raise the rear of the disc harrow.

Ensure the tractor's adjustable stabilizer arms are centered and locked for optimal discing. The most common position for effective use will be level front to back and side to side. Experience will allow the operator to determine the best setting for the application.

DETACHING FROM THREE POINT HITCH

1. Lower disc harrow to the ground.
2. Engage tractor parking brake and/or place transmission in "PARK". Shut off tractor engine and remove key.
3. Remove quick lock pints from lift pins.
4. Disconnect top link from disc harrow lift arms. Position tractor top link in transport location.
5. Remove the tractor's lower 3-point lift arms from lift pins.
6. Start tractor engine and carefully drive tractor away.

OPERATION

Safety is a primary concern in the design and manufacture of our products. Unfortunately, our efforts to provide safe equipment can be wiped out by an operator's single careless act. In addition to the design and configuration of equipment, hazard control and accident prevention are dependent upon the awareness, concern, judgment, and proper training of personnel involved in the operation, transport, maintenance, and storage of equipment. The operator is responsible for the safe operation of this equipment.

The operator must be properly trained. Operator's should be familiar with the equipment, the tractor, and all safety practices before starting operation. Read the safety rules and safety decals on pages 1 through 8.

This equipment is designed for cutting sod, breaking clumps and leveling soil for seedbed preparation.

Recommended tractor ground speed is should not exceed 6 mph.



WARNING

- **DO NOT place hands, feet, or other limbs underneath disc blades. Notched and smooth disc blades are sharp and may cause serious injury.**
- **Certain applications require operators to reach underneath disc harrow frame. Be aware of possible pinch points, crushing hazards, and proximity of hands, feet, and other limbs to disc blades.**
- **Keep all persons away from operation control area while performing adjustments, service, or maintenance.**
- **Never allow children or untrained persons to operate equipment.**
- **Never allow riders on power unit or attachment.**
- **Power unit must be equipped with ROPS or ROPS cab and seat belt. Keep seat belt securely fastened. Falling off power unit can result in death from being run over or crushed. Keep foldable ROPS system in "locked up" position at all times.**



WARNING

- **A minimum 20% of tractor and equipment weight must be on the tractor front wheels when attachments are in transport position. Without this weight, tractor could tip over, causing personal injury or death. The weight may be attained with a loader, front wheel weights, ballast in tires or front tractor weights. Weigh the tractor and equipment. Do not estimate.**
- **Before dismounting power unit or performing service or maintenance, follow these steps: disengage power to equipment, lower 3-point hitch and all raised components to the ground, operate valve levers to release any hydraulic pressure, set parking brake, stop engine, remove key, unfasten seat belt.**



CAUTION

- **Always wear relatively tight and belted clothing to avoid getting caught in moving parts. Wear sturdy, rough-soled work shoes and protective equipment for eyes, hair, hands, hearing, and head; and respirator or filter mask where appropriate.**
- **Review and follow all safety rules and safety decal instructions.**
- **Check that all hardware is properly installed and secured.**
- **Check that equipment is properly and securely attached to tractor.**
- **Stop power unit and equipment immediately upon striking an obstruction. Turn off engine, remove key, inspect, and repair any damage before resuming operation.**

ADJUSTING GANG ANGLES

The front gangs are independently adjustable and have four (4) positions between 2.5 and 15 degrees. Increasing the gang angle leads to a more aggressive cut. The greater the disc angle, the greater the material turnover. Although gang sets are independently adjustable, left and right gang should always be adjusted to the same angle. Adjustments can be made by following these instructions:

1. With disc harrow attached to tractor, lower the implement to level ground.
2. Engage tractor parking brake and/or place transmission in "PARK" Shut off tractor engine and remove key.
3. Each gang assembly has two bearing hangers that attach to the disc harrow frame with 1/2"-13 x 1-1/2" bolts secured with 1/2" nylon lock nuts (two bolts and two nuts on each bearing hanger). Loosen bolts on both bearing hangers.

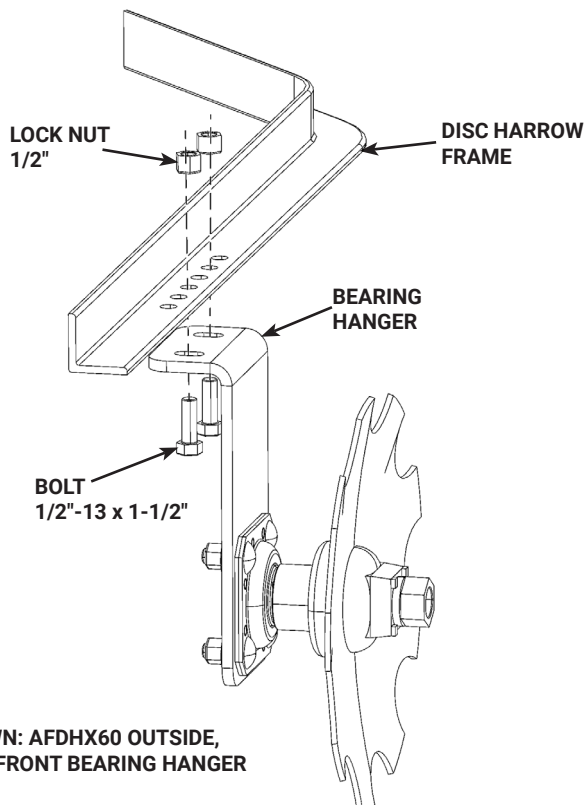

SHOWN: AFDHX60 OUTSIDE, LEFT FRONT BEARING HANGER



WARNING

- If implement is not lowered completely to the ground, gang assembly will drop when bolts are loosened and removed.
- Watch for possible pinch points and crushing hazards.
- DO NOT place hands, feet, or other limbs underneath disc blades. Disc blades are sharp and may cause serious injury.
- Keep bystanders away from equipment.

4. Adjusting the gang angle requires removing the bolts from either the outer or inner bearing hanger (all four bolts may need to be removed for certain configurations). Remove necessary bolts.
5. Start tractor engine. Use 3-point lift to raise implement just high enough to allow clearance to move gang assembly.
6. Engage tractor parking brake and/or place transmission in "PARK". Shut off tractor engine and remove key.



WARNING

- Hydraulic system leak down, hydraulic system failures, mechanical failures, or movement of control levers can cause implement to drop or move unexpectedly and cause serious injury or death.
- Keep bystanders away from equipment.

7. Set gang assembly to desired angle and reinsert bolts through bearing hanger and disc harrow frame. Ensure bolt head sits on the underside of bearing hanger.
8. Secure bolts with nylon lock nuts. Torque to proper specifications (see chart on page 20). Bearing hangers should be flush with bottom of disc harrow frame.

The information in this section is written for operators who possess basic mechanical skills. For your protection, read and follow the safety information in this manual. If you need help, your dealer has trained service technicians available.

WARNING

- **DO NOT** place hands, feet, or other limbs underneath disc blades. Notched and smooth disc blades are sharp and may cause serious injury.
- Certain applications require operators to reach underneath disc harrow frame. Be aware of possible pinch points, crushing hazards, and proximity of hands, feet, and other limbs to disc blades.
- Keep all persons away from operation control area while performing adjustments, service, or maintenance.
- Never allow children or untrained persons to operate equipment.
- Before dismounting power unit or performing service or maintenance, follow these steps: disengage power to equipment, lower 3-point hitch and all raised components to the ground, operate valve levers to release any hydraulic pressure, set parking brake, stop engine, remove key, unfasten seat belt.

CAUTION

- Always wear relatively tight and belted clothing to avoid getting caught in moving parts. Wear sturdy, rough-soled work shoes and protective equipment for eyes, hair, hands, hearing, and head; and respirator or filter mask where appropriate.
- Review and follow all safety rules and safety decal instructions.

TIGHTENING DISC GANGS AFDHX60

The main hex nuts on all disc gangs should be tightened after the first use and after every eight (8) hours of operation.

1. With disc harrow lowered to level ground, use a 1-1/2" socket to tighten main hex nut. Torque to proper specifications (see chart on page 20).

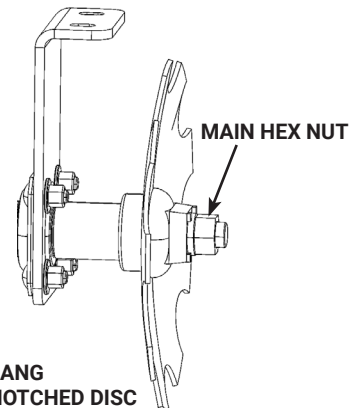

SHOWN: AFDHX60 REAR LEFT GANG
INNER BEARING HANGER AND NOTCHED DISC

REPLACING DISC BLADES & BEARINGS AFDHX60

Disassemble Gang

1. Ensure disc harrow is sitting on level ground.
2. If disc harrow is attached to tractor, securely block tractor wheels to prevent rotation. Engage tractor parking brake and/or place transmission in "PARK". Shut off tractor and remove key.
3. Each gang assembly has two bearing hangers that attach to the disc harrow frame with 1/2"-13 x 1-1/2" bolts secured with 1/2" nylon lock nuts (two bolts and two nuts on each bearing hanger). Loosen and remove nuts and bolts on both bearing hangers.

| |
|--|
|  WARNING |
| <ul style="list-style-type: none"> • If implement is not lowered completely to the ground, gang assembly will drop when bolts are loosened and removed. • DO NOT place hands, feet, or other limbs underneath disc blades. Notched and smooth disc blades are sharp and may cause serious injury. • Keep bystanders away from equipment. |

4. Use a lifting device to raise disc harrow until gang assembly is free from frame.

| |
|---|
|  WARNING |
| <ul style="list-style-type: none"> • Gang assembly may shift or roll when detached from disc harrow frame. • Watch for possible pinch points and crushing hazards. • Notched and smooth disc blades are sharp and may cause serious injury. |

5. Use a 1-1/2" socket to remove main hex nut from gang assembly. Remove lock washer and continue to disassemble gang until component needing replaced is reached.

| |
|--|
| NOTE |
| <ul style="list-style-type: none"> • Maintain proper order of discs, spacers, washers, and bearings for reassembly. Front and rear disc gangs have specific assembly orders. |

Assemble Gang

1. Reassemble gang with new disc(s) and bearing(s) according to (image).
2. Install lock washer and main hex nut. Torque main hex nut to proper specifications (see chart on page 20)
3. Lower disc harrow, aligning frame bolt holes with bearing hanger bolt holes.

| |
|--|
|  WARNING |
| <ul style="list-style-type: none"> • Watch for possible pinch points and crushing hazards. • DO NOT place hands, feet, or other limbs underneath disc blades. Notched and smooth disc blades are sharp and may cause serious injury. |

4. Insert bolts through bearing hanger and disc harrow frame. Ensure bolt head sits on the underside of bearing hanger.
5. Secure with nylon lock nuts. Torque lock nuts to proper specifications.

REPLACING DISC BLADES & BEARINGS AFDHX60 (continued)

NOTE: Orientation based on forward movement of the implement

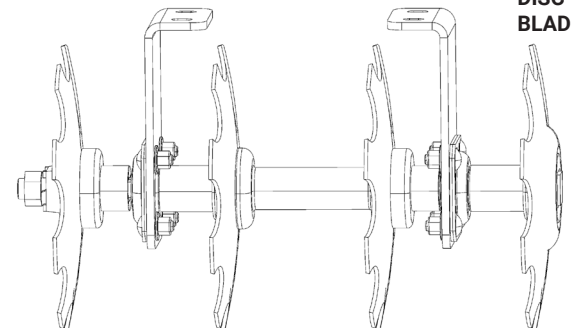
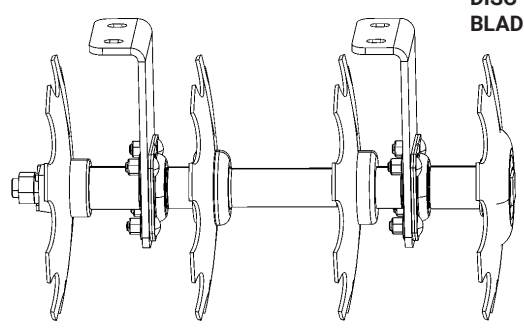
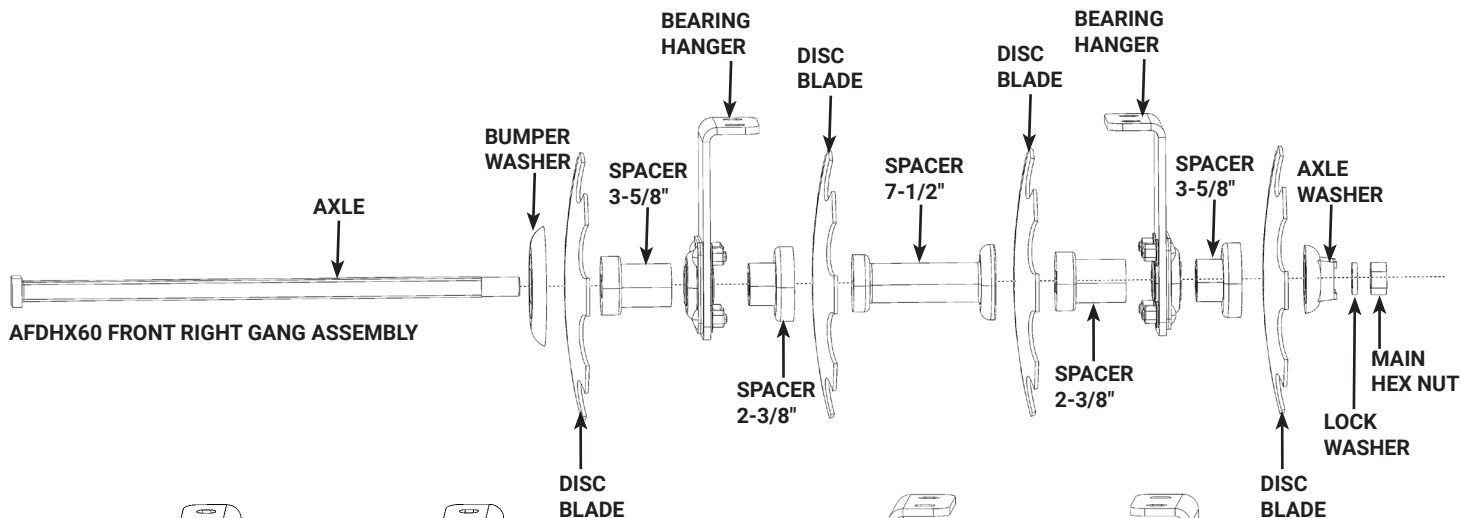
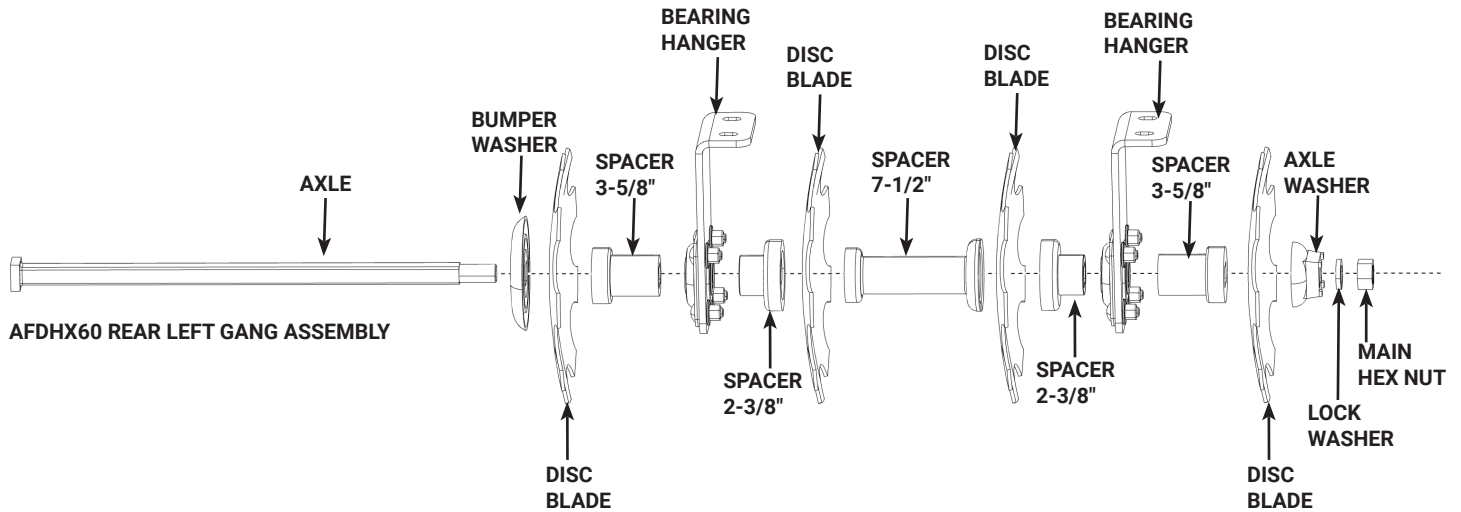
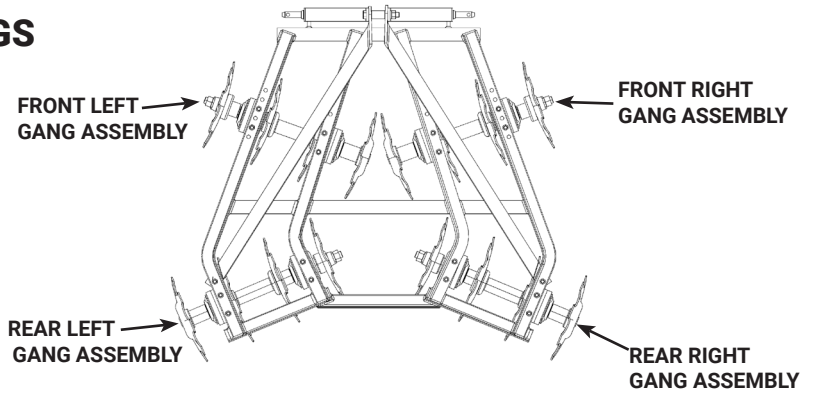

CLEANING

After Each Use

- Remove large debris such as clumps of dirt, grass, crop residue, etc. from machine.
- Inspect machine and replace worn or damaged parts.
- Replace any safety decals that are missing or not readable.

Periodically or Before Extended Storage

- Clean large debris such as clumps of dirt, grass, crop residue, etc. from machine.
- Remove the remainder using a low-pressure water spray.
 1. Be careful when spraying near scratched or torn safety decals or near edges of decals as water spray can peel decal off surface.
 2. Be careful when spraying near chipped or scratched paint as water spray can lift paint.
 3. If a pressure washer is used, follow the advice of the pressure washer manufacturer.
 4. Do not spray pressurized water near the sealed bearings on the gang assemblies.
- Inspect machine and replace worn or damaged parts.
- Sand down scratches and the edges of areas of missing paint and coat with spray paint of matching color (purchase from your dealer).
- Replace any safety decals that are missing or not readable. See Safety Decals section for location drawing.

STORAGE



Always use a power unit to position implement for storage.

Block the implement securely for storage.

Keep children and bystanders away from storage area.

SPECIFICATIONS

| Model | AFDHX60 |
|-----------------------------|--------------------------------|
| Dimensions | |
| Working Width, in. | 62.5 |
| Length, in. | 53 |
| Height, in. | 32 |
| Weight | |
| Implement, lb | 407 |
| Tractor Requirements | |
| PTO hp | 18-32 |
| Discs | |
| Number of Disc Blades | 16 |
| Disc Blade Types | 14"x3mm notched |
| Disc Blade Spacing, in. | 7.5 |
| Gang Assembly | |
| Gang Angle, degrees | 2.5 - 15 |
| Bearing Type | Replaceable sealed, 2 per gang |
| Gang Tube | N/A |
| Hitch | |
| Type | Cat. 0 (Cat. 1 pins installed) |
| Quick-Hitch Compatibility | No |

AFDHX60 FRAME PARTS

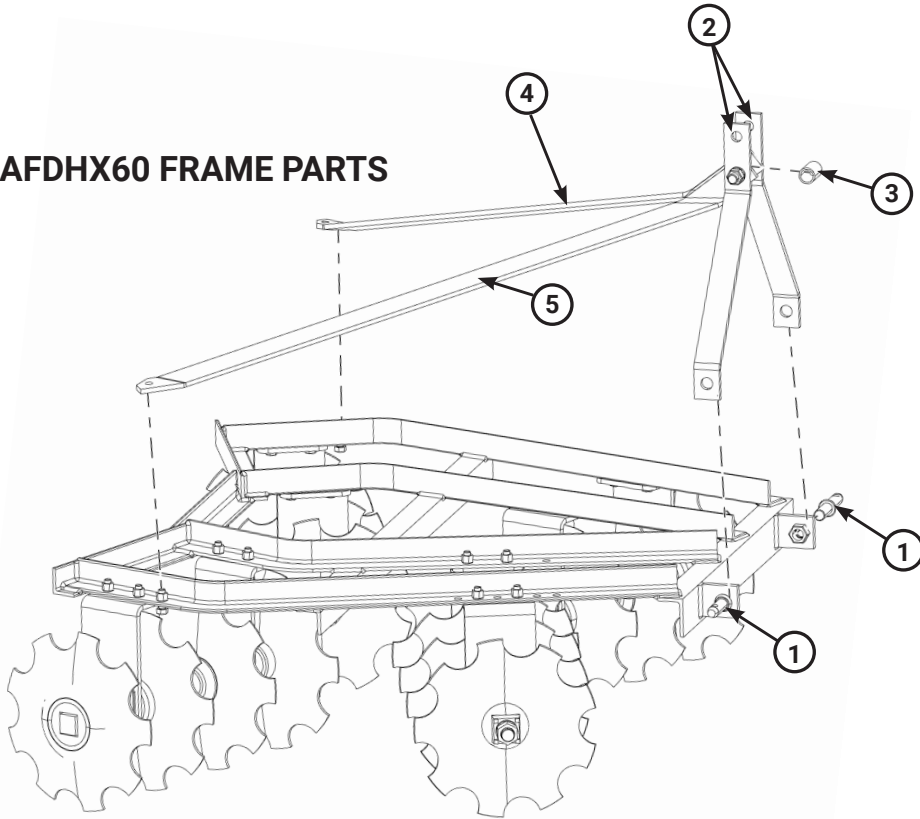

AFDHX60 GANG ASSEMBLY

(IMAGE ROTATED 90° COUNTERCLOCKWISE)

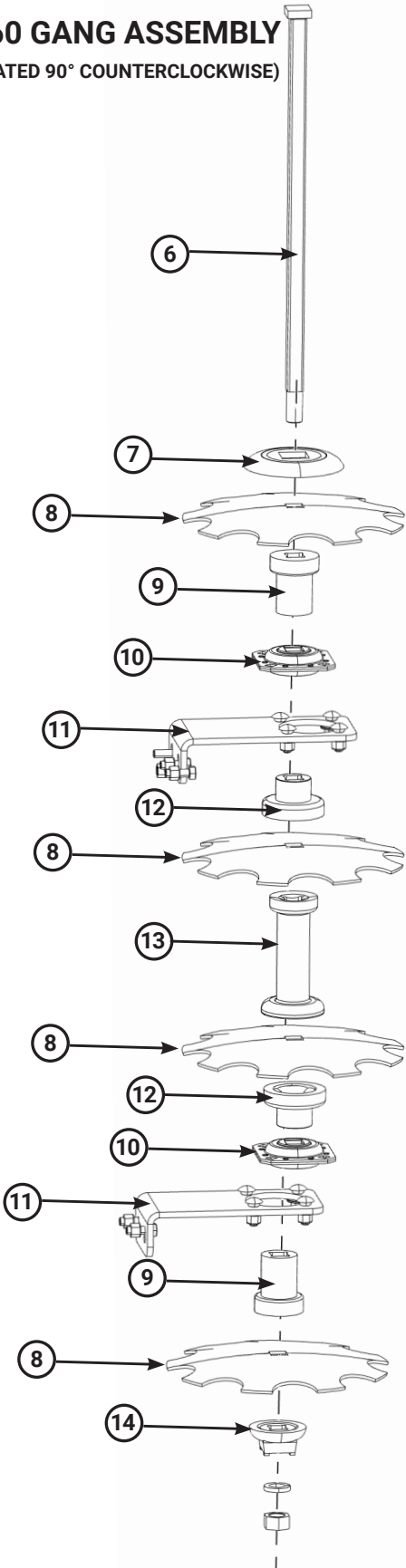

| Item Number | Part Number | Description |
|-------------|-------------|--------------------------------|
| 1 | C1L | Category 1 Lift Pin |
| 2 | 9000669 | AFDHX60 Lift Arm (2pk) |
| 3 | 9000218 | Lift Arm Spacer (Black) |
| 4 | 9000670 | AFDHX60 Lift Arm Brace (Left) |
| 5 | 9000671 | AFDHX60 Lift Arm Brace (Right) |
| 6 | 1A26 | Axle |
| 7 | DWL | Bumper Washer |
| 8 | NDB14 | 14" Notched Disc Blade |
| 9 | 358S | Spacer 3-5/8" |
| 10 | HDDBA | Sealed Bearing Assembly |
| 11 | 9000621 | 5' Disc Harrow Bearing Stand |
| 12 | 238S | Spacer 2-3/8" |
| 13 | PS7 | Spacer 7-1/2" |
| 14 | DWS | Axle Washer |

TROUBLESHOOTING

| PROBLEM | POSSIBLE REMEDY |
|---|---|
| Unit not tracking or is fishtailing. | <ul style="list-style-type: none"> A. Adjust top link to increase weight on the rear of the disc. B. Ensure adjustable stabilizer arm on tractor is locked. C. Ensure disc is assembled correctly and all bolts tightened to proper torque specifications. |
| Unit not tracking: skipping, jumping, and fishtailing (in untilled, hard soil). | <ul style="list-style-type: none"> A. Ensure equal cut or depth on front and rear. B. Ensure adjustable stabilizer arm on tractor is locked. C. Reduce speed. D. Reduce gang angle. E. Reduce depth of cut by carrying on 3-point lift, discing shallow the first time over. NOTE: Some experimentation may be required by trial and error to arrive at proper solution. |
| Unit leaving water furrow in center. | <ul style="list-style-type: none"> A. Increase speed. B. Decrease angle on front gangs. C. Disc not level. Lower rear gangs or raise front gangs. D. Any combination of the above. |
| Unit ridging or leaving behind a high spot in center of machine. | <ul style="list-style-type: none"> A. Decrease speed. B. Increase angle on front gangs. C. Disc not level. Raise rear gangs or lower front gangs. D. Any combination of the above. |
| Blades plugging with soil or trash. | <ul style="list-style-type: none"> A. Soil conditions not suitable for discing due to excessive moisture. |

TORQUE SPECIFICATIONS

AMERICAN Bolt Head Markings

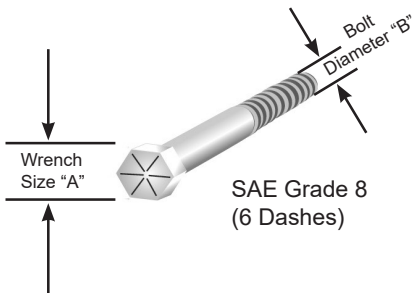

Proper torque for American fasteners used on manufactured implement.
Recommended Torque in Foot Pounds (Newton Meters).*

| WRENCH SIZE (IN.) "A" | BOLT DIAMETER (IN.) "B" AND THREAD SIZE | SAE GRADE 2 | SAE GRADE 5 | SAE GRADE 8 |
|-----------------------|---|-------------|-------------|-------------|
| 7/16 | 1/4 - 20 UNC | 6 (7) | 8 (11) | 12 (16) |
| 7/16 | 1/4 - 24 UNF | 6 (8) | 10 (13) | 14 (18) |
| 1/2 | 5/16 - 18 UNC | 11 (15) | 17 (23) | 25 (33) |
| 1/2 | 5/16 - 24 UNF | 13 (17) | 19 (26) | 27 (37) |
| 9/16 | 3/8 - 16 UNC | 20 (27) | 31 (42) | 44 (60) |
| 9/16 | 3/8 - 24 UNF | 23 (31) | 35 (47) | 49 (66) |
| 5/8 | 7/16 - 14 UNC | 32 (43) | 49 (66) | 70 (95) |
| 5/8 | 7/16 - 20 UNF | 36 (49) | 55 (75) | 78 (106) |
| 3/4 | 1/2 - 13 UNC | 49 (66) | 76 (103) | 106 (144) |
| 3/4 | 1/2 - 20 UNF | 55 (75) | 85 (115) | 120 (163) |
| 7/8 | 9/16 - 12 UNC | 70 (95) | 109 (148) | 153 (207) |
| 7/8 | 9/16 - 18 UNF | 79 (107) | 122 (165) | 172 (233) |
| 15/16 | 5/8 - 11 UNC | 97 (131) | 150 (203) | 212 (287) |
| 15/16 | 5/8 - 18 UNF | 110 (149) | 170 (230) | 240 (325) |
| 1 1/8 | 3/4 - 10 UNC | 144 (195) | 266 (360) | 376 (509) |
| 1 1/8 | 3/4 - 16 UNF | 192 (260) | 297 (406) | 420 (569) |
| 1 5/16 | 7/8 - 9 UNC | 166 (225) | 430 (583) | 606 (821) |
| 1 5/16 | 7/8 - 14 UNF | 184 (249) | 474 (642) | 668 (905) |
| 1 1/2 | 1 - 8 UNC | 250 (339) | 644 (873) | 909 (1232) |
| 1 1/2 | 1 - 12 UNF | 274 (371) | 705 (955) | 995 (1348) |
| 1 1/2 | 1 - 14 UNF | 280 (379) | 721 (977) | 1019 (1381) |
| 1 11/16 | 1 1/8 - 7 UNC | 354 (480) | 795 (1077) | 1288 (1745) |
| 1 11/16 | 1 1/8 - 12 UNF | 397 (538) | 890 (1206) | 1444 (1957) |
| 1 7/8 | 1 1/4 - 7 UNC | 500 (678) | 1120 (1518) | 1817 (2462) |
| 1 7/8 | 1 1/4 - 12 UNF | 553 (749) | 1241 (1682) | 2013 (2728) |
| 2 1/16 | 1 3/8 - 6 UNC | 655 (887) | 1470 (1992) | 2382 (3228) |
| 2 1/16 | 1 3/8 - 12 UNF | 746 (1011) | 1672 (2266) | 2712 (3675) |
| 2 1/4 | 1 1/2 - 6 UNC | 870 (1179) | 1950 (2642) | 3161 (4283) |
| 2 1/4 | 1 1/2 - 12 UNF | 979 (1327) | 2194 (2973) | 3557 (4820) |

METRIC

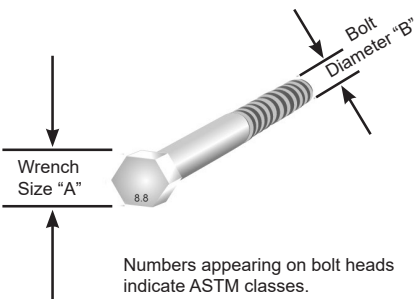

Proper torque for metric fasteners used on manufacturer implement.
Recommended Torque in Foot Pounds (Newton Meters).*

| WRENCH SIZE (mm) "A" | BOLT DIA. (mm) "B" | ASTM 4.6 | ASTM 8.8 | ASTM 9.8 | ASTM 10.9 |
|----------------------|--------------------|-----------|-------------|-----------|-------------|
| 8 | 5 | 1.8 (2.4) | | 5.1 (6.9) | 6.5 (8.8) |
| 10 | 6 | 3 (4) | | 8.7 (12) | 11.1 (15) |
| 13 | 8 | 7.3 (10) | | 21.1 (29) | 27 (37) |
| 16 | 10 | 14.5 (20) | | 42 (57) | 53 (72) |
| 18 | 12 | 25 (34) | 74 (100) | 73 (99) | 93 (126) |
| 21 | 14 | 40 (54) | 118 (160) | 116 (157) | 148 (201) |
| 24 | 16 | 62 (84) | 167 (226) | 181 (245) | 230 (312) |
| 30 | 20 | 122 (165) | 325 (440) | | 449 (608) |
| 33 | 22 | | 443 (600) | | 611 (828) |
| 36 | 24 | 211 (286) | 563 (763) | | 778 (1054) |
| 31 | 27 | | 821 (1112) | | 1138 (1542) |
| 46 | 30 | 418 (566) | 1119 (1516) | | 1547 (2096) |

*Use 75% of the specified torque value for plated fasteners. Use 85% of the specified torque values for lubricated fasteners.

WARRANTY

Manufacturer's Limited Warranty

Summit Tractors LLC, 3379 Peachtree Road NE Suite 555 Atlanta, Ga 30326, warrants to the original purchaser that the purchased product is free from defects in material and workmanship for a period of one (1) year commencing on the date of original purchase, as evidenced by the original receipt, and will, at its option, repair, replace, or issue credit for any product or part found to be defective.

This limited warranty shall only apply if this product has been operated and maintained in accordance with the Operator's Manual furnished with the product, and has not been subject to misuse, abuse, commercial or industrial use, neglect, improper maintenance, alteration or accident, or which has been used for a purpose for which the product was not designed. Damage resulting from the installation or use of any part, accessory, or attachment not approved by Summit Tractors LLC, for use with the product covered by the Operator's Manual, shall void the warranty as to any resulting damage.

This limited warranty is extended solely to the original purchaser of the product. Should the original purchaser sell or otherwise transfer this product to a third party, this warranty does not transfer to the third party in any manner.

Warranty Disclaimer

This limited warranty is in lieu of, and Summit Tractors LLC disclaims and excludes any express and implied warranties with respect to the product including, without limitation, merchantability and fitness for a particular purpose. No other express warranty, whether written or oral, given by any person or entity, including a retailer, with respect to any product, shall bind Summit Tractors LLC.

Summit Tractor LLC's exclusive liability for breach of the limited warranty, as set forth above, on the product shall be to repair or replace the product within the warranty period in accordance with the terms of this limited warranty. The choice of remedy shall belong solely to Summit Tractor LLC. In no event shall Summit Tractor LLC be liable for any loss or damages of any other kind, whether direct, incidental, consequential including lost profits, exemplary, special or otherwise, including without limitation, expenses incurred for substitute or replacement product or for rental expenses to temporarily replace a warranted product.

Under no circumstance shall recovery, of any kind, be greater than the amount of the purchase price of the product purchased. Customer assumes all risk and liability for loss, damage, or injury to customer or customer's property and/or the property of others arising out of the misuse or inability to use the product.

Legal Rights

This limited warranty gives you specific legal rights, and you may also have other rights which may vary from state to state. Some states do not allow any limitation on how long an implied warranty lasts or the exclusion or limitation of incidental or consequential damages, so the above limitations may not apply to you.

Additional Information

Contact your authorized dealer for complete warranty information and assistance with warranty claims. Retain original sales receipt, and record the model number, serial number, and the date of purchase in the spaces provided below. This information will be helpful to the dealer if parts or service are required.

Warranty Claim Information

Dealer Name

Dealer Address

Dealer Phone

Dealer Email

Purchase Date

Model Number

Serial Number/UPC





PART NO.
4000966

International Tractors
USA Corporation
1900 Parrish Drive SE
Rome, GA 30161

770-209-3390
support@summittractors.com

